

Step 1

Check dwelling for a minimum of one exit. Exit door cannot be accessed by traveling through the garage.

Step 2

Verify that basements with habitable space and all sleeping rooms have a means of emergency escape and rescue (door or window) which conforms to Section R310.1 through R310.1.4 for size, area and location.

Sections R310.1 through R310.1.4 Emergency Escape and Rescue Openings

Item	Requirement
Nongrade floor windows	<ul style="list-style-type: none"> Maximum 44 inches from the floor to top of sill Minimum net clear height equals 24 inches and minimum net clear width equals 20 inches Minimum net clear opening equals 5.7 square feet Operable from inside to the required full clear opening without use of a key or tool
Grade floor windows <i>Basement</i>	<ul style="list-style-type: none"> Maximum top of 44 inches above the finished grade to top of sill Minimum net clear height equals 24 inches and minimum net clear width equals 20 inches Minimum net clear opening equals 5.0 square feet Operable from inside to the required full clear opening without use of a key or tool Window openings with a finished sill height below the adjacent grade shall be provided with a window well per Section R310.2
Doors may be used as the emergency egress if:	<ul style="list-style-type: none"> Occupants can exit to the exterior Operable from inside to the required full clear opening without use of a key or tool

Example of Clear Opening Dimensions

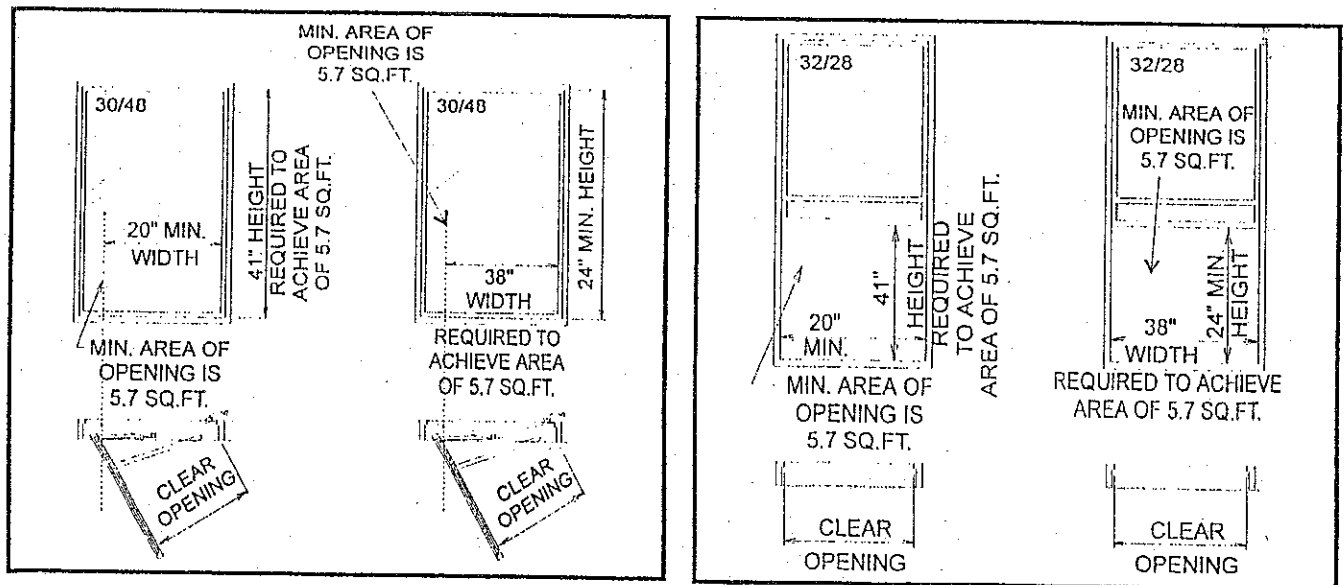

Casement

Double Hung

Step 2, continued

Note: Section R310.4 prohibits bars, grills, covers and screens or similar devices from obstructing a required escape and rescue window or window well unless the security device is removable or releasable from the inside without the use of a key or tool or force greater than required for normal operation of the window.

Example of Window Well

*Horizontal dimensions of window well must allow the window to open fully and have a minimum net clear area of 9 sq. ft. with minimum dimensions of 3'-0"

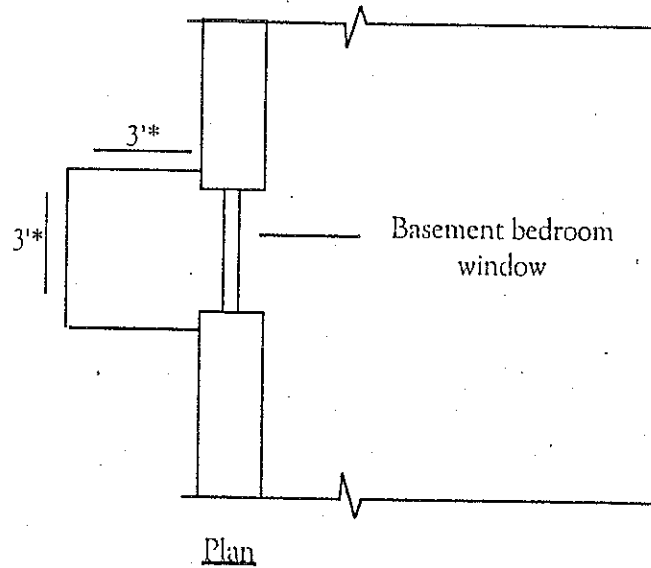

Example of Window Well

* No ladder or steps required if depth is 44" or less. If depth is greater than 44" then a ladder or steps are required.

